

Museum Lonfor Sunda

by Mingzhe Lu / 2019-06-07 15:18:50 / Internacional / 4194 / EN

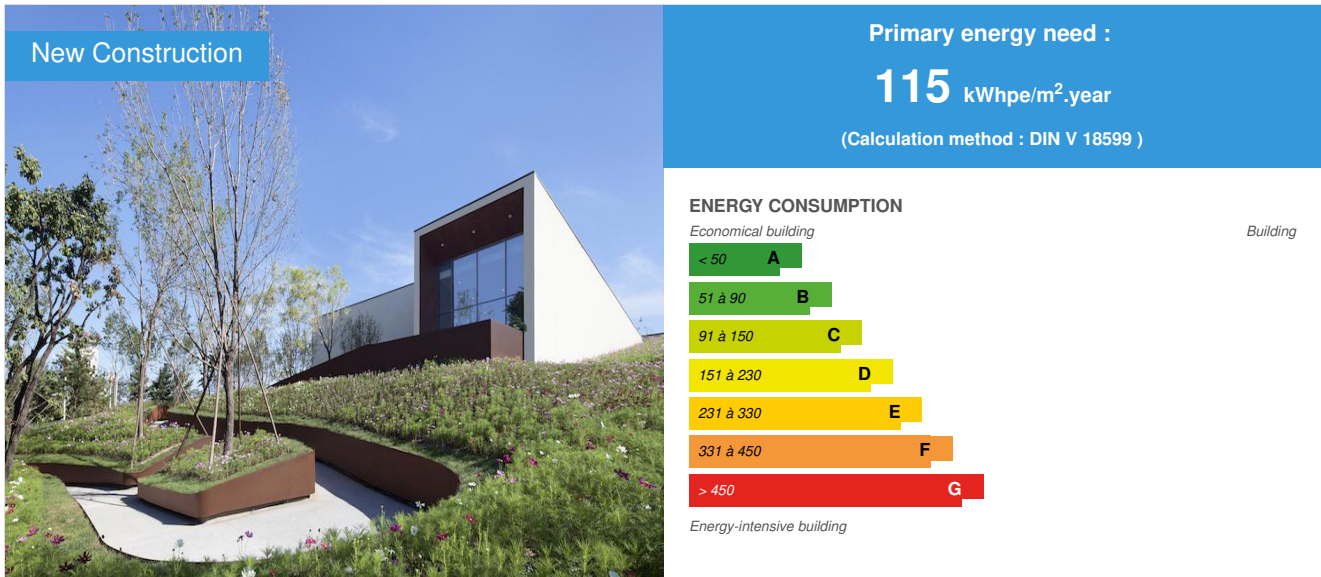

Building Type : Museum
Construction Year : 2017
Delivery year : 2017
Address 1 - street : Gaobeidian City 07400 GAOBEIDIAN, China
Climate zone : [Dwb] Humid Continental Mild Summer, Dry Winter

Net Floor Area : 1 350 m² Superficie útil
Construction/refurbishment cost : 2 800 000 €
Number of Visitor : 1 Visitor
Cost/m2 : 2074.07 €/m²

Certifications :



Proposed by :



General information

The Passive House Technology Museum in Gaobeidian (Hebei Province) is the world's first Passive House Museum to showcase Passive House technology developed in Germany. The reference project is a testimony to successful cooperation between German and Chinese specialist engineers, manufacturers and construction companies. The German service company LUTHER Design headed the energetic and technical consulting for sustainable building of the project and was responsible for the Passive House and DGNB certification of the building.

The property is located in a newly planned low-energy development area, which acts as a national demonstration area for sustainable buildings. A new Ecopark has also been created there.

The architectural form of the museum is based on the energy-saving passive house construction and has some special features. For example, the building has various levels and passages that connect the interior spaces with the garden design. The exterior structure of the museum building enables the extremely low

energy consumption of the building and contributes to its environmental friendliness by following the four design elements of the Passive House standard:

- The museum has a compact building form which minimizes the body shape coefficient and reduces the heat loss of the external structure of the building;
- Pollution during the construction process is reduced due to the use of prefabricated modules;
- The object has an all-glass wooden facade on the south side in combination with a fully movable, adjustable, intelligent exterior shading system. According to the recorded indoor and outdoor temperature and humidity, the heat is maximized in winter and the building is protected from excess solar radiation in the summer;
- The roofing on the north side improves the insulation performance of the outer protective structure.

At the same time, LUTHER Design developed real-time data acquisition devices for environmental monitoring inside and outside the building. Among other things, this measure allows the measurement of indoor and outdoor temperature, humidity, particulate matter (PM 2.5), the angle of incidence of sunlight and the energy consumption of fresh air devices. The collected data can then be viewed in real time on a display for the visitors of the museum and give a good impression of the comfort, the achieved energy saving and the considerable economic advantages of the passive house.

The project is the result of successful international cooperation between Germany and China. In addition, the museum is one of the first Chinese-built buildings of this quality with such a high energy standard. Overall, the reference object offers new perspectives for the client and the Chinese government. It makes clear that the future of the construction sector is sustainable and that the Passive House - with its high energy efficiency and environmental friendliness, as well as its healthy and comfortable indoor climate - makes a fundamental contribution to this development.

See more details about this project

https://passivehouse-database.org/#d_5423

Photo credit

Luther Design

Stakeholders

Contractor

Name : Luther Design Freie Architekten
Contact : Frankfurt am Main
<http://www.luther-design.com>

Construction Manager

Name : Beijing Tsinghua Tongheng Urban Planning & Design Institute
Contact : Beijing

Stakeholders

Function : Designer
Prof. Yehao Song

Contracting method

Other methods

Energy

Energy consumption

Primary energy need : 115,00 kWhpe/m².year
Calculation method : DIN V 18599
Breakdown for energy consumption : Annual heating demand : 12 kWh/m²a
Heating load : 8 W/m²

Cooling & dehum. demand: 14 kWh/(m²a)
Cooling load: 7 W/m²

Envelope performance

More information :

Exterior wall : U-value = 0.101 W/(m²K)

Basement floor / floor slab : U-value = 0.13 W/(m²K)

Roof : U-value = 0.126 W/(m²K)

Frame : U w-value = 0.89 W/(m²K)

Thermal envelope information:

- Coating 15mm
- Expanded clay aggregate 250mm
- EPS 032 250mm
- EPS 032 50mm

Basement floor / floor slab:

- Coating: 15 mm
- Reinforced concrete: 450 mm
- XPS 250mm
- brick: 120 mm

Roof:

- Earth: 80mm
- Mortar: 50 mm
- EPS 032: 250 mm
- Concrete: 120 mm

Frame:

- RAICO, THERM+ 56 H-i - SW
- Wooden façade

Glazing

- Window glazing: Saint Gobain
- Glazing north and south façades: Taibo Group
- Glazed skylight: Hengeda

Entrance door:

- RAICO wooden façade
- THERM+ 56 H-i SWISSP. V

Indicator : n50

Air Tightness Value : 0,20

More information

Calculated according to PHPP

Real final energy consumption

Final Energy : 115,00 kWh/m².year

Renewables & systems

Systems

Heating system :

- Heat pump

Hot water system :

- Heat pump

Cooling system :

- Geothermal heat pump

Ventilation system :

- humidity sensitive Air Handling Unit (hygro A)

Renewable systems :

- Heat pump

Other information on HVAC :

Centralized air ventilation system with heating and cooling function and heat exchanger.
80% heat recovery

Environment

Urban environment

The property is located in a newly planned low-energy development area, which acts as a national demonstration area for sustainable buildings. A new Ecopark has also been created there.

Products

Product

THERM+ H-I

Raico

<https://www.raico.de>

Product category : Table 'c21_spain.innov_category' doesn't exist SELECT one.innov_category AS current,two.innov_category AS parentFROM innov_category AS oneINNER JOIN innov_category AS two ON one.parent_id = two.idWHERE one.state=1AND one.id = '6'
<https://www.raico.de/en/Products/THERM.php>

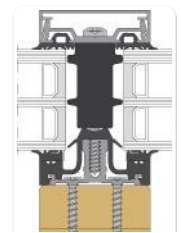

Costs

Construction and exploitation costs

Additional information on costs :

3000 €/m2 Treated Floor Area according to PHPP (Costs of group 200-700)

Contest

Reasons for participating in the competition(s)

The architectural form of the museum is based on the energy-saving passive house construction and has some special features. For example, the building has various levels and passages that connect the interior spaces with the garden design. The exterior structure of the museum building enables the extremely low energy consumption of the building and contributes to its environmental friendliness by following the four design elements of the Passive House standard:

- The museum has a compact building form which minimizes the body shape coefficient and reduces the heat loss of the external structure of the building;
- Pollution during the construction process is reduced due to the use of prefabricated modules;
- The object has an all-glass wooden facade on the south side in combination with a fully movable, adjustable, intelligent exterior shading system. According to the recorded indoor and outdoor temperature and humidity, the heat is maximized in winter and the building is protected from excess solar radiation in the summer;
- The roofing on the north side improves the insulation performance of the outer protective structure.

At the same time, LUTHER Design developed real-time data acquisition devices for environmental monitoring inside and outside the building. Among other things, this measure allows the measurement of indoor and outdoor temperature, humidity, particulate matter (PM 2.5), the angle of incidence of sunlight and the energy consumption of fresh air devices. The collected data can then be viewed in real time on a display for the visitors of the museum and give a good impression of the comfort, the achieved energy saving and the considerable economic advantages of the passive house.

Building candidate in the category

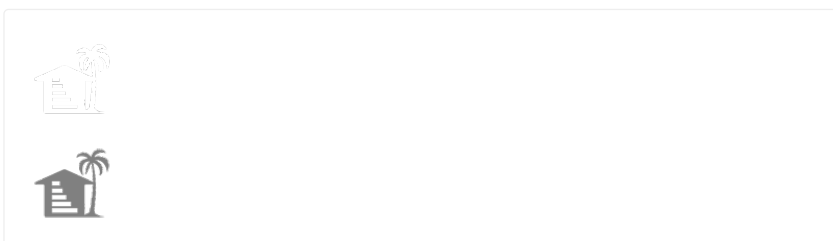

Energy & Hot Climates



Low Carbon



Health & Comfort



Users' Choice

