

Oveliance Agefos

by Nathalie MEHU / 2017-05-19 11:17:07 / Frankreich / 7196 / FR

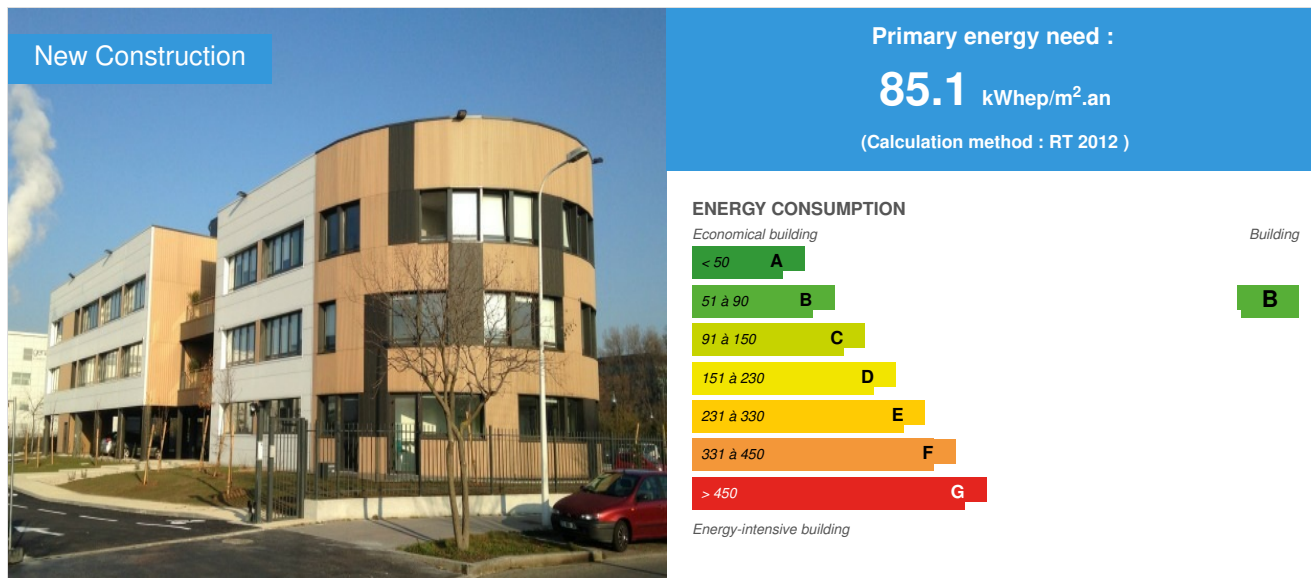

Building Type : Office building < 28m
Construction Year : 2016
Delivery year : 2016
Address 1 - street : Rue Pierre-Gilles de Genne 69007 LYON, France
Climate zone : [Cfb] Marine Mild Winter, warm summer, no dry season.

Net Floor Area : 1 876 m²
Construction/refurbishment cost : 2 698 000 €
Number of Work station : 180 Work station
Cost/m2 : 1438.17 €/m²

Certifications :



General information

Oveliance is a 1795 square meter office design that is designed to promote sharing and communication with many places of conviviality imagined inside the trays and on the floor levels. This project was carried out by Novélige, a subsidiary of VINCI Construction France.

Sustainable development approach of the project owner

"At VINCI, we believe that there is no economic success without a human project. This is rooted in our culture. We are also convinced that our social, societal and environmental performance is an asset for our development, as it is an increasing expectation of our clients and international investors. That is why we published our Manifesto in 2012, in which we make eight intangible and universal commitments. It is a common framework that all VINCI entities must appropriate according to their businesses and markets. I personally oversee the mobilization of all Group managers. " Xavier Huillard Commitment N ° 3 - Together for Green Growth!

We participate in the prospective reflection on the city and sustainable mobility. Our innovations, resulting from eco-design, enable us to improve the energy and environmental performance of our infrastructures. We are committed to reducing our greenhouse gas emissions by 30% by 2020, supporting our customers in their search for better energy efficiency and encouraging them to adopt eco-responsible behavior. Each project is imagined by ensuring its integration into its environment, as well as the quality of the living environment it offers. VINCI Construction France created Blue Fabric, its vision to build responsibly, and thus meet the four challenges of the sustainable city. Competitiveness: to give the city seductive assets, by building buildings and equipment with high functionality, economically efficient, sustainable, accessible, affordable, with loads optimized. Creativity: to accompany the designers and their vision, by providing them with innovative solutions and proven techniques. Conviviality: reflect on the scale of the neighborhood and the diversity of its activities, mixing housing, offices, shops and attractive public spaces to promote the meeting. Consensus: working collaboratively and transparently with all project stakeholders - investors, customers, architects, public authorities, network managers - but also local residents and associations.

Architectural description

Designed to promote sharing and communication with convivial spaces inside the trays and on the landing, it comprises on the ground floor, a large modular meeting room adjoining the luminous reception area. The two floors, served by a glazed elevator, let the natural light shine through. To improve this feeling of comfort, an interior architect intervened to distill a few touches of color and promote the circulation of employees inside the building.

Stakeholders

Stakeholders

Function : Others

NOVELIGE

BILLIER Frederic

<http://www.novelige-construction.fr/>

General Contractor / Designer / Constructor

Function : Contractor

AGEFOS

<http://www.agefos-pme.com/site-national/accueil/>

Function : Thermal consultancy agency

Industherm

Geraud BULLY

Energy

Energy consumption

Primary energy need : 85,10 kWh/m².an

Primary energy need for standard building : 110,00 kWh/m².an

Calculation method : RT 2012

Renewables & systems

Systems

Heating system :

- Heat pump

Hot water system :

- Other hot water system

Cooling system :

- Reversible heat pump

Ventilation system :

- Double flow heat exchanger

Renewable systems :

- Heat pump

Environment

Urban environment

Ovéliance AGEFOS is located in an industrial area close to public transport.

Products

Product

CLAD Cladding

Neolife

304, RN6-Celtic Parc Bâtiment Avalon II, 69760 Limonest ; contact@neolife-solutions.com

<https://www.neolife-solutions.com>

Product category : Table 'c21_germany.innov_category' doesn't exist SELECT one.innov_category AS current,two.innov_category AS parentFROM innov_category AS oneINNER JOIN innov_category AS two ON one.parent_id = two.idWHERE one.state=1AND one.id = '6'

The wood cladding is reconstituted by a minimum of 90% of wood fibers with a clear-track appearance and blades that can be combined with waves of 4 or 14 centimeters. Their fixings are made on wooden bedding, the installation is fast and adjusted.

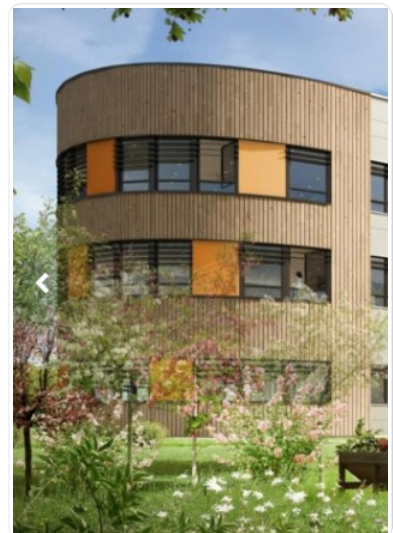

DECK Platform

NEOLIFE

304, RN6-Celtic Parc Bâtiment Avalon II, 69760 Limonest ; contact@neolife-solutions.com

<https://www.neolife-solutions.com>

Product category : Table 'c21_germany.innov_category' doesn't exist SELECT one.innov_category AS current,two.innov_category AS parentFROM innov_category AS oneINNER JOIN innov_category AS two ON one.parent_id = two.idWHERE one.state=1AND one.id = '16'

The wood decking consists of a minimum of 82% of wood fibers with 30 centimeter wide, solid or alveolar blades. The fixing can be done on any support with possibility of unit disassembly of the blades without damage. Dimensional stability allows reduced expansion joints. The decking is rot-proof, there is no development of foams or molds.

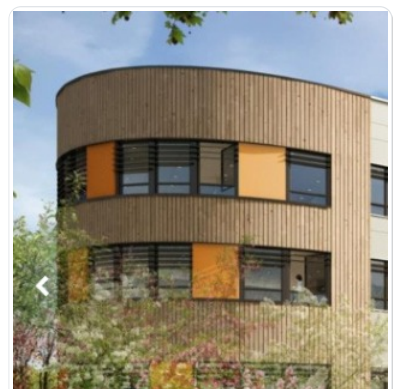

Costs

Carbon

GHG emissions

GHG in use : 3,47 KgCO₂/m²/an

Methodology used :

Calculation RT2012

GHG before use : 0,20 KgCO₂ /m²

Building lifetime : 50,00 année(s)

, ie xx in use years : 0.06

GHG Cradle to Grave : 700,00 KgCO₂ /m²

Calculation BBCA Elodie

Contest

Building candidate in the category



Bas Carbone



Coup de Cœur des Internautes

